

MCS200

Multi Connector System
SF2000 Solenoid Valve MOUNTED

- DC 24V / DC 12V
- 25Pin D-Sub Connector
- Simple Electric Wire System

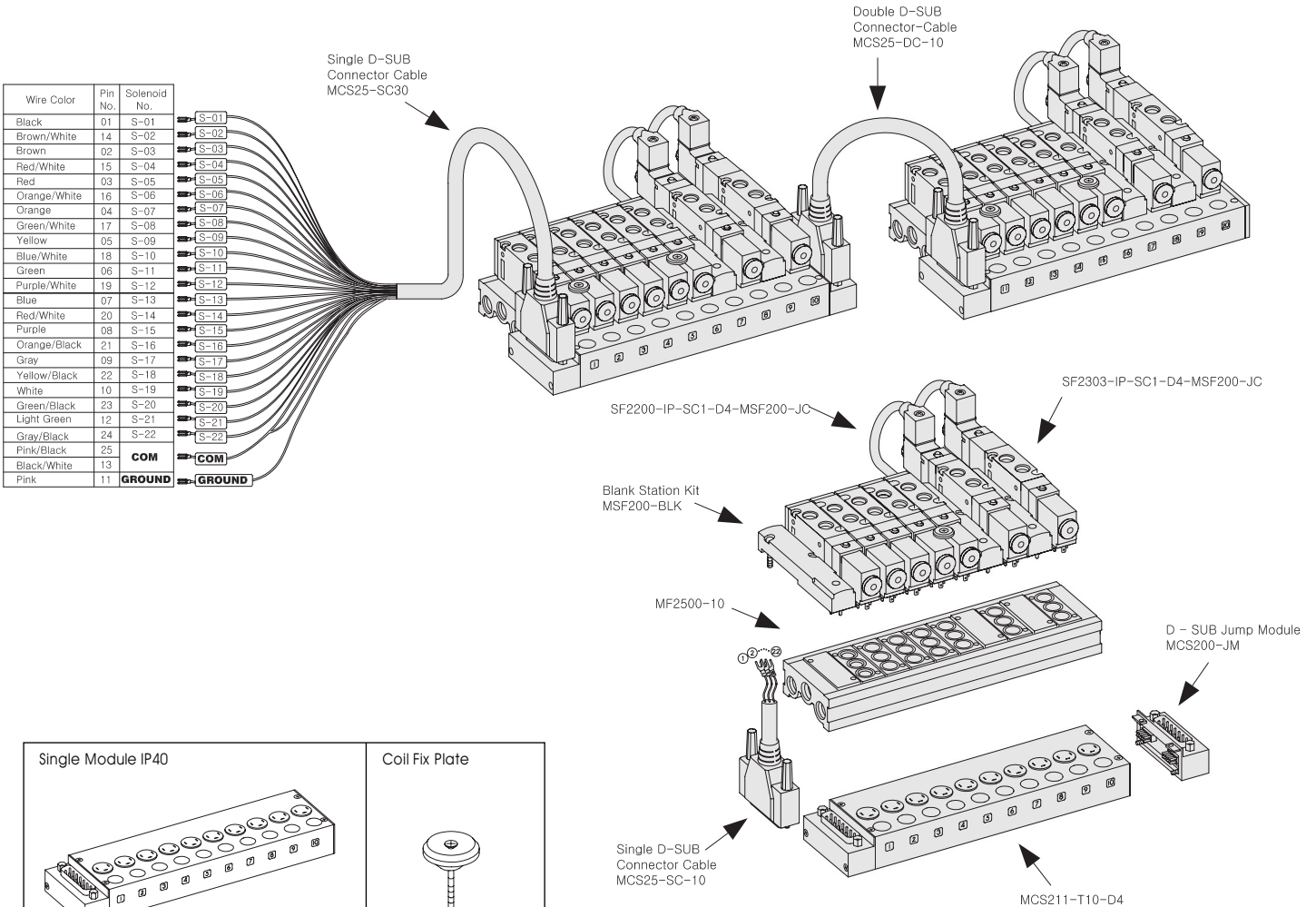

<p>Single Module IP40</p> <p>Ordering Code MCS211-T10-D4</p>	<p>Coil Fix Plate</p> <p>Ordering Code MCS200-CP</p>
--	--

<p>Double Module IP40</p> <p>Ordering Code MCS221-T10-D4</p>	<p>D-Sub Jump Module IP40 (Material : Zinc)</p> <p>Ordering Code MCS200-JM</p>	<p>Single D-Sub Connector Cable IP40</p> <p>Ordering Code MCS25-SC-10 (1m) MCS25-SC-30 (3m) MCS25-SC-50 (5m) MCS25-SC-100 (10m)</p>	<p>Double D-Sub Connector Cable IP40</p> <p>Ordering Code MCS25-DC-05 (0.5m) MCS25-DC-10 (10m)</p>	<p>Blank Station Kit (Material : Zinc)</p> <p>Ordering Code MSF200-BLK</p>	<p>Jump Connector Kit IP40</p> <p>Ordering Code MSF200-JC</p>
--	--	---	--	--	---

ORDERING NO.

MCS2 1 1 - T04 - D4

Series	Function	D-Sub Connector	Multipole Wireway Box	Voltage																														
MCS2 : SF2000-1/8-5Port Solenoid Valve Ass'y	<table border="1"> <tr><td>0</td><td>None</td></tr> <tr><td>1</td><td>Single Module</td></tr> <tr><td>2</td><td>Double Module</td></tr> </table>	0	None	1	Single Module	2	Double Module	<table border="1"> <tr><td>0</td><td>None</td></tr> <tr><td>1</td><td>25 Pin D-Sub Connector</td></tr> </table>	0	None	1	25 Pin D-Sub Connector	<table border="1"> <tr><td>0</td><td>None</td></tr> <tr><td>T04</td><td>4 Station</td></tr> <tr><td>T06</td><td>6 Station</td></tr> <tr><td>T08</td><td>8 Station</td></tr> <tr><td>T10</td><td>10 Station</td></tr> <tr><td>T12</td><td>12 Station</td></tr> <tr><td>T14</td><td>14 Station</td></tr> </table>	0	None	T04	4 Station	T06	6 Station	T08	8 Station	T10	10 Station	T12	12 Station	T14	14 Station	<table border="1"> <tr><td>0</td><td>None</td></tr> <tr><td>D4</td><td>DC 24V</td></tr> <tr><td>D2</td><td>DC 12V</td></tr> </table>	0	None	D4	DC 24V	D2	DC 12V
0	None																																	
1	Single Module																																	
2	Double Module																																	
0	None																																	
1	25 Pin D-Sub Connector																																	
0	None																																	
T04	4 Station																																	
T06	6 Station																																	
T08	8 Station																																	
T10	10 Station																																	
T12	12 Station																																	
T14	14 Station																																	
0	None																																	
D4	DC 24V																																	
D2	DC 12V																																	

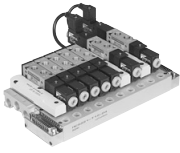
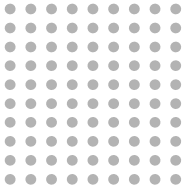

MCS211-T10-D4

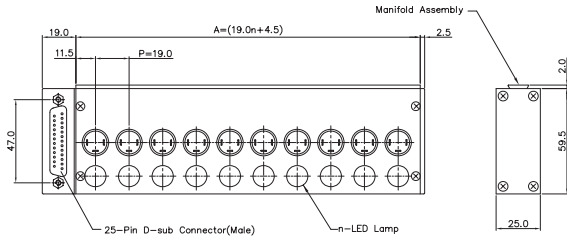

MCS221-T10-D4

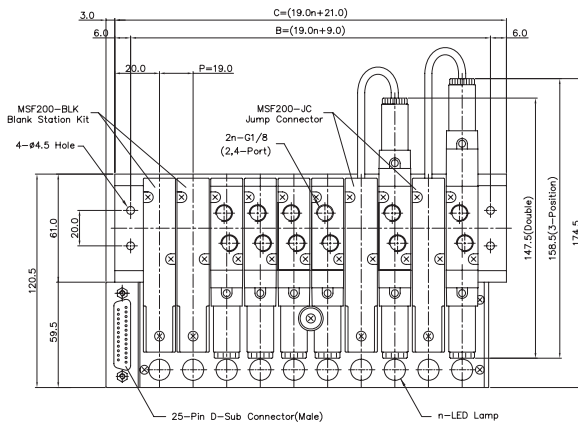
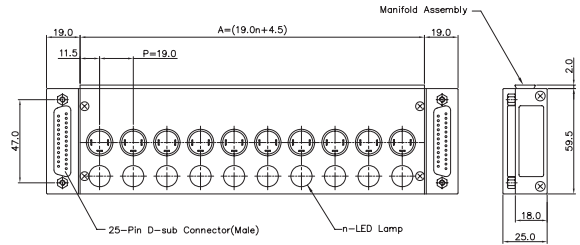

n = STATION

ITEM	n	4	6	8	10	12	14
A		80.5	118.5	156.5	194.5	232.5	270.5
B		85.0	123.0	161.0	199.0	237.0	275.0
C		97.0	135.0	173.0	211.0	249.0	287.0

D-Sub Connector Pin No.

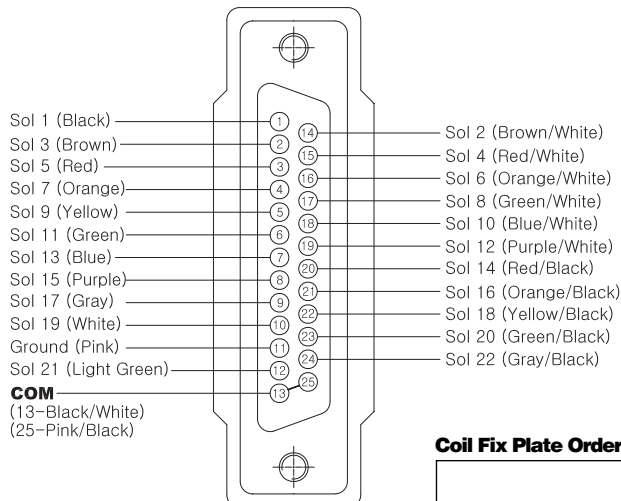

Coil Fix Plate Ordering Code

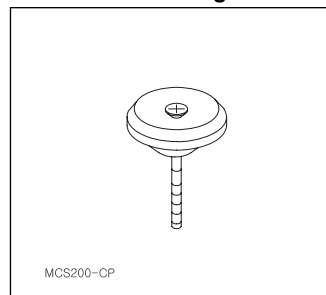

Blank Station Kit Ordering Code

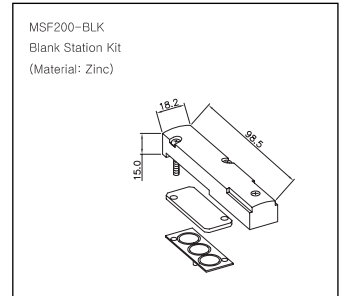

Jump Connector Cable Ordering Code

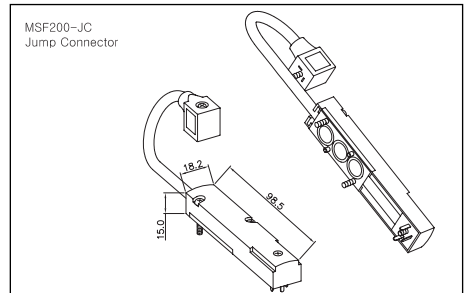

Single D-Sub Connector Cable Ordering Code

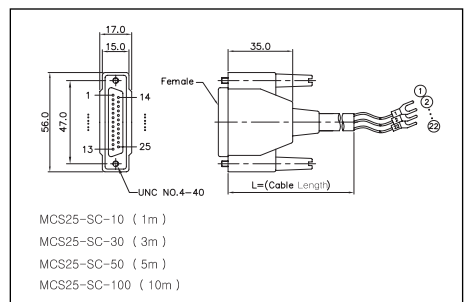

Double D-Sub Connector Cable Ordering Code

