

# S-UJ2E series

Pneumatic Mufflers With Granulate Filling



Reference	Connection	D	L
P2B7W	G 1/8"	16.0	26
P2B7X	G 1/4"	20.0	35
P2B7Y	G 3/8"	24.0	47
P2B7Z	G 1/2"	24.0	47
P2B82	G 3/4"	HEX 50	97
P2B83	G 1"	HEX 50	97

## ENGLISH

**Operating pressure:**  
max. 6 bar (87 psi)

**Advantages:**  
Self-cleaning by the granular filling

## NEDERLANDS

**Bedrijfsdruk:**  
max. 6 bar

**Voordelen:**  
Zelfreinigend door granulaatvulling

## DEUTSCH

**Betriebsdruck:**  
max. 6 bar

**Vorteile:**  
Selbstreinigend durch  
Granulatfüllung

## FRANÇAIS

**Pression de service:**  
max. 6 bar

**Avantages:**  
Autonettoyant via un remplissage  
granulaire

# S-UJ2E series

Pneumatic Mufflers With Granulate Filling

## Dimensions

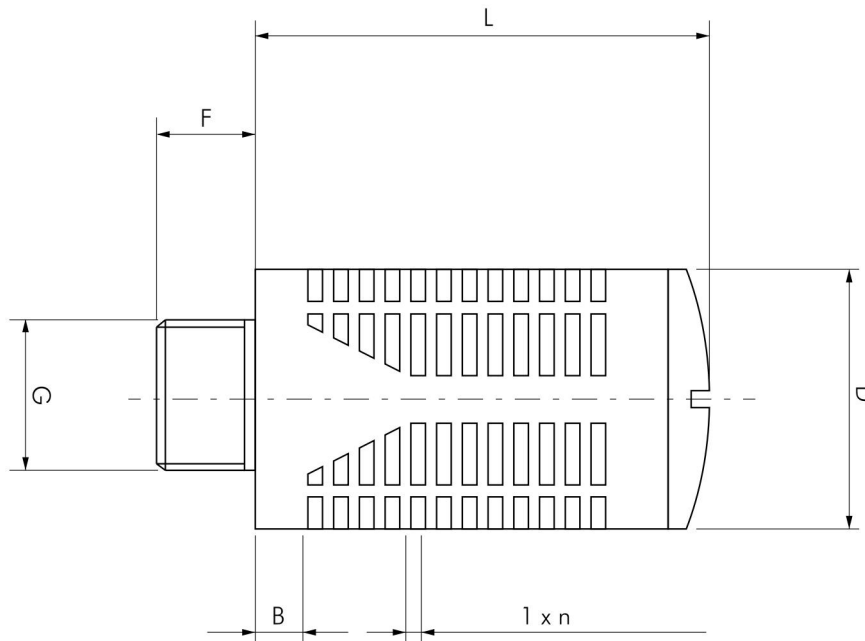

Reference	Connection	D	L	F	B	n
P2B7W	G 1/8"	16.0	26±0.5	6.5±0.3	2	12
P2B7X	G 1/4"	20.0	35±0.5	8.0±0.3	3	15
P2B7Y	G 3/8"	24.0	47±0.5	10.0±0.3	4	19
P2B7Z	G 1/2"	24.0	47±0.5	10.0±0.3	4	19
P2B82	G 3/4"	HEX 50	97±1.0	18.5±0.5	8	39
P2B83	G 1"	HEX 50	97±1.0	18.5±0.5	8	39