

FL2S-FM-B - series

Bulkhead screw connections, up to 40 bar

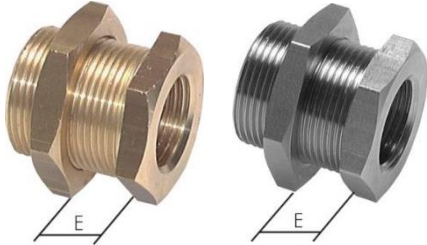

Reference	Material	Surface protection	Nominal inner diameter of connection 1 (G1)	Nominal outer diameter of connection 2 (G2)	Max pressure (bar)
FL2S-FM-BN-M5-018G-B	Brass	Nickel-plated	M5	G 1/8 inch	16
FL2S-FM-BN-018G-014G-B	Brass	Nickel-plated	G 1/8 inch	G 1/4 inch	16
FL2S-FM-BN-014G-038G-B	Brass	Nickel-plated	G 1/4 inch	G 3/8 inch	16
FL2S-FM-BN-038G-012G-B	Brass	Nickel-plated	G 3/8 inch	G 1/2 inch	16
FL2S-FM-BN-012G-M28-B	Brass	Nickel-plated	G 1/2 inch	M28 x 1.5	16
FL2S-FM-BN-034G-M34-B	Brass	Nickel-plated	G 3/4 inch	M34 x 2	16
FL2S-FM-B-M5-018G-B	Brass		M5	G 1/8 inch	16
FL2S-FM-B-018G-014G-B	Brass		G 1/8 inch	G 1/4 inch	16
FL2S-FM-B-014G-038G-B	Brass		G 1/4 inch	G 3/8 inch	16
FL2S-FM-B-038G-012G-B	Brass		G 3/8 inch	G 1/2 inch	16
FL2S-FM-B-012G-M28-B	Brass		G 1/2 inch	M28 x 1.5	16
FL2S-FM-B-034G-M34-B	Brass		G 3/4 inch	M34 x 2	16
FL2S-FM-B-100G-M42-B	Brass		G 1 inch	M42 x 2	16
FL2S-FM-B-114G-M49-B	Brass		G 1 1/4 inch	M49 x 2	16
FL2S-FM-B-112G-M54-B	Brass		G 1 1/2 inch	M54 x 2	16
FL2S-FM-ST-018G-014G-B	Stainless steel		G 1/8 inch	G 1/4 inch	40
FL2S-FM-ST-014G-038G-B	Stainless steel		G 1/4 inch	G 3/8 inch	40
FL2S-FM-ST-038G-012G-B	Stainless steel		G 3/8 inch	G 1/2 inch	40
FL2S-FM-ST-012G-M28-B	Stainless steel		G 1/2 inch	M28 x 1.5	40
FL2S-FM-ST-034G-M34-B	Stainless steel		G 3/4 inch	M34 x 2	40
FL2S-FM-ST-100G-M42-B	Stainless steel		G 1 inch	M42 x 2	40
FL2S-FM-ST-114G-M49-B	Stainless steel		G 1 1/4 inch	M49 x 2	40
FL2S-FM-ST-112G-M54-B	Stainless steel		G 1 1/2 inch	M54 x 2	40

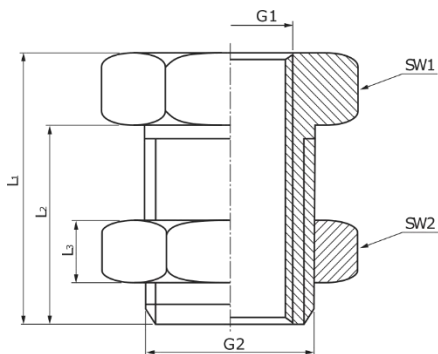

Brass, nickel-plated	Brass	Stainless steel	E max	Installation borehole (mm)	SW1 (mm)	SW2 (mm)	L1 (mm)	L2 (mm)	L3 (mm)
FL2S-FM-BN-M5-018G-B	FL2S-FM-B-M5-018G-B		8	10	14	14	15	12	4
FL2S-FM-BN-018G-014G-B	FL2S-FM-B-018G-014G-B	FL2S-FM-ST-018G-014G-B	10	14	17	17	18	14	4
FL2S-FM-BN-014G-038G-B	FL2S-FM-B-014G-038G-B	FL2S-FM-ST-014G-038G-B	14	17	22	22*	22	18*	4*
FL2S-FM-BN-038G-012G-B	FL2S-FM-B-038G-012G-B	FL2S-FM-ST-038G-012G-B	16	21.5	24	27	26	21	5
FL2S-FM-BN-012G-M28-B	FL2S-FM-B-012G-M28-B	FL2S-FM-ST-012G-M28-B	20	28.5	32	36	33	27	7
FL2S-FM-BN-034G-M34-B	FL2S-FM-B-034G-M34-B		24	34.5	41	41	36	30	6
	FL2S-FM-B-100G-M42-B		26	42.5	46	50	42	34	8
	FL2S-FM-B-114G-M49-B		29.5	49.5	55	55	47	39	9.5
	FL2S-FM-B-112G-M54-B		29	54.5	60	60	47	39	10

* FL2S-FM-ST-018G-014G-B: SW2 = 19, L2 = 17, L3 = 5