

PW Unequal Union Y

RoHS compliant

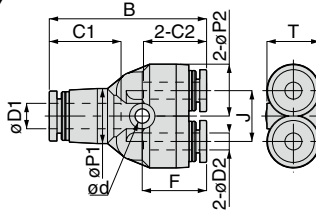

OP. P.754

3D CAD

CAD

Unit : mm

Model code	Tube O.D. øD1	Tube O.D. øD2	B	øP1	øP2	Tube end C1	Tube end C2	J	ød	F	T	Orifice bore (ømm)	Weight (g)	CAD file name
PW6-4④	6	4	37.2	13	12.5	17	14.9	12	3.4	15.2	13.5	3.7	11	PW6-4
PW8-4④	8	4	41.9	14.5	12.5	18.1	14.9	14	3.4	16.7	15.1	3.9	13	PW8-4
PW8-6④		6	42.5				17			17.3		5		PW8-6
PW10-6④	10	6	48.2	17.5	14.5	20.2	17	18	4.5	19.3	18.2	5.7	19	PW10-6
PW10-8④		8	48.1				18.1			19.2		6.5		20
PW12-8④	12	8	54.3	21	17.5	23.4	18.1	20	4.5	21.7	21.7	7.5	27	PW12-8
PW12-10④		10	54.6				20.2			22		7.8		30
PW16-12④	16	12	62.3	25	25	24.1	23.4	24	4.5	22.2	25	9	48	PW16-12
PW3/16-5/32④	3/16	5/32	37.6	13	12.5	17.4	14.9	12	3.4	15.2	13.5	3.7	11	PW3_16-5_32
PW1/4-4④	1/4	4	37.2	13	12.5	17	14.9	12	3.4	15.2	13.5	3.7	11	PW1_4-4
PW1/4-5/32④		5/32	37.2				17.4			16.2		4		PW1_4-5_32
PW1/4-3/16④		3/16	38.1				14.9			16.7		3.9		PW1_4-3_16
PW5/16-5/32④	5/16	5/32	41.9	14.5	12.5	18.1	17	14	3.4	17.3	15.1	5	13	PW5_16-5_32
PW5/16-1/4④		1/4	42.5				17			19.3		5.7		19
PW3/8-1/4④	3/8	1/4	48.2	17.5	14.5	20.2	17	18	4.5	19.2	18.2	6.5	20	PW3_8-1_4
PW3/8-5/16④		5/16	48.1				18.1			19.2		6.5		20
PW1/2-5/16④	1/2	5/16	54.6	21	17.5	23.7	18.1	20	4.5	21.7	21.7	7.5	27	PW1_2-5_16
PW1/2-3/8④		3/8	54.9				20.2			22		7.8		30

※ 1. ④ in Model code / Replaced with "W" for Light-gray color, "-C" for Clean-room package, "-WC" for Light-gray color and Clean-room package, "-UC" for Clean-wash and Clean-room package

※ 2. Orifice bore is the smallest passage converted in terms of the diameter.

FITTING

CONTROLLER

VALVE

TUBE

MAKE-TO-ORDER PRODUCTS

76

Standard Series

Mini Series

Stainless Series

Chemical Series

PP Series

EG Series

Anti-siphon & Press Series

Gas Conversion Control

Minimal Series

Stop Fitting Series

Rotary Series

Twist-Proof Fitting

Block and Connector

Coupling

Color Cap