

**PC Straight**

RoHS compliant

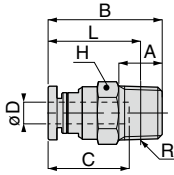

Metric thread type

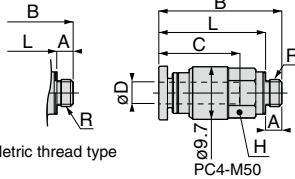

PC4-M50

Unit : mm



Model code	Tube O.D. øD	R	A	B	L	Tube end C	Hex. H	Orifice bore (ømm)	Weight (g)	CAD file name
PC4-M5 (4)	4	M5 × 0.8	2.8 [3]	19.8	17 [16.8]	14.9	10	2.4	5.6	PC4-M5_[C]
PC4-M50 (4)			22.7	19.9 [19.7]	8		6.1		PC4-M50_[C]	
PC4-M6 (4)		M6 × 1	3.8	20.8	17		10	6	PC4-M6_[C]	
PC4-01 (4)			R1/8	8	21		17	3	7.4	PC4-01_
PC4-02 (4)			R1/4	11	22.5		16.5	14	16	PC4-02_
PC6-M5 (4)	6	M5 × 0.8	2.8 [3]	21.9	19.1 [18.9]	17	12	2.4	8.1	PC6-M5_[C]
PC6-M6 (4)			3.8	22.9	19.1			3	8.5	PC6-M6_[C]
PC6-01 (4)		R1/8	8	22.3	18.3		14	5	8.2	PC6-01_
PC6-02 (4)		R1/4	11	23.7	17.6				15	PC6-02_
PC6-03 (4)		R3/8	12	24.5	18.1				17	28
PC8-01 (4)	8	R1/8	8	27.9	23.9	18.2	14	6	14	PC8-01_
PC8-02 (4)		R1/4	11	26.6	20.6				7	25
PC8-03 (4)		R3/8	12	25.5	19.2		17	25	PC8-03_	
PC10-01 (4)	10	R1/8	8	30.3	26.3	20.7	17	6	21	PC10-01_
PC10-02 (4)		R1/4	11	29.8	23.8				8.5	19
PC10-03 (4)		R3/8	12	29.3	23			9	24	PC10-03_
PC10-04 (4)		R1/2	15	30.4	22.2		21		46	PC10-04_
PC12-02 (4)	12	R1/4	11	35.9	29.9	23.3	21	8.5	37	PC12-02_
PC12-03 (4)		R3/8	12	31.9	25.6				11	30
PC12-04 (4)	12	R1/2	15	33.9	25.7	24.8	24	11	44	PC12-04_
PC16-03 (4)		R3/8	12	39.3	33				11	54
PC16-04 (4)	16	R1/2	15	41.3	33.1	24.8	24	13	63	PC16-04_
PC5/32-M5 (4)		5/32	M5 × 0.8	2.8 [3]	19.8				17 [16.8]	14.9
PC5/32-01 (4)	R1/8		8	21	17	14	3	7.4	PC5_32-01_	
PC5/32-02 (4)	R1/4		11	22.5	16.5			16	16	
PC3/16-M5 (4)	3/16	M5 × 0.8	2.8 [3]	22.3	19.5 [19.3]	17.4	12	2.4	8.6	PC3_16-M5_[C]
PC3/16-01 (4)		R1/8	8	22.7	18.7				14	4
PC3/16-02 (4)		R1/4	11	24.1	18		16	16		
PC1/4-M5 (4)	1/4	M5 × 0.8	2.8 [3]	21.9	19.1 [18.9]	17	12	2.4	8	PC1_4-M5_[C]
PC1/4-01 (4)		R1/8	8	22.3	18.3					14
PC1/4-02 (4)		R1/4	11	23.7	17.6		17	28	PC1_4-02_	
PC1/4-03 (4)		R3/8	12	24.5	18.1		17	28	PC1_4-03_	
PC5/16-01 (4)	5/16	R1/8	8	27.9	23.9	18.2	14	6	14	PC5_16-01_
PC5/16-02 (4)		R1/4	11	26.6	20.6				17	7
PC5/16-03 (4)		R3/8	12	25.5	19.2		17	25		
PC3/8-01 (4)	3/8	R1/8	8	30.3	26.3	20.7	17	6	22	PC3_8-01_
PC3/8-02 (4)		R1/4	11	29.8	23.8				8.5	19
PC3/8-03 (4)		R3/8	12	29.3	23		21	47		
PC3/8-04 (4)		R1/2	15	30.4	22.2				21	47
PC1/2-02 (4)	1/2	R1/4	11	35.7	29.7	23.1	21	8.5	36	PC1_2-02_
PC1/2-03 (4)		R3/8	12	31.7	25.4				11	29
PC1/2-04 (4)		R1/2	15	33.7	25.5		43	43		PC1_2-04_
PC5/8-03 (4)	5/8	R3/8	12	39.3	33	24.8	24	11	54	PC5_8-03_
PC5/8-04 (4)		R1/2	15	41.3	33.1				13	63

※ 1. ④ in Model code / Replaced with "W" for Light-gray color, "-C" for Clean-room package, "-W-C" for Light-gray color and Clean-room package, "-UC" for Clean-wash and Clean-room package

※ 2. "L" is a reference value for height dimension after tightening taper thread.

※ 3. Dimensions in [ ] are for clean-room and clean-wash package products.

※ 4. Orifice bore is the smallest passage converted in terms of the diameter.

FITTING

COMPOLLER

VALVE

TUBE

MADE-TO-ORDER

PRODUCTS

44

Standard Series

Mini Series

Stainless Series

Chemical Series

PP Series

EG Series

Anti-siphon & Back-Flow Series

Self-Compensating Control

Minimal Series

Stop Fitting Series

Rotary Series

Twist-Proof Fitting

Block and Connector

Color Cap