

piINLINE® vacuum generator MICRO Si, 6-6 mm, 0122882



- Patented COAX® cartridge technology....
- High vacuum flow capacity in relation to energy consumption.
- Low weight inline design with push-in fittings.
- Quick and easy installation directly on the hose.
- Si/Ti cartridge at 0.6 MPa for extra vacuum flow.
- Bi cartridge for reliability at low feed pressures.
- Ti/Xi cartridge at 0.4/0.5 MPa when high flow and deep vacuum is needed.

General

Item number, alternative	E12841166
Material	CuZn, PA, SS, TPE, Nitrile (NBR)
Noise level	67 – 73 dBA
Temperature	-10 – 80 °C
Weight	9.8 g

Performance

Feed pressure, max.	0.7 MPa
---------------------	---------

Vacuum flow

Feed pressure MPa	Air consumption NI/s	Vacuum flow (NI/s) at different vacuum levels (-kPa)										Max vacuum -kPa
		0	10	20	30	40	50	60	70			
0.6	0.12	0.28	0.21	0.12	0.08	0.07	0.06	0.04	0.02	0.02	75	

Evacuation time

Feed pressure MPa	Air consumption NI/s	Evacuation time (s/l) to reach different vacuum levels (-kPa)								Max vacuum -kPa
		10	20	30	40	50	60	70		
0.6	0.12	0.41	1.01	2.01	3.3	4.9	6.9	10.2	75	

Blow flow

Feed pressure MPa	Air consumption NI/s	Blow flow (NI/s) at different pressure levels (kPa)										Max pressure kPa
		0	10	20	30	40	50	60	70			
0.6	0.12	0.4	0.34	0.22	0.21	0.2	0.18	0.17	0.15	70		

Dimensional drawings

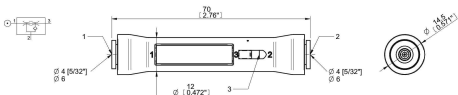

Values specified in the data sheet are tested at:

Room temperature	(20°C [68°F] ± 3°C [5.5°F])
Standard atmosphere	(101.3 [29.9 inHg] ± 1.0 kPa [0.3 inHg])
Relative humidity	0-100%
Compressed air quality	DIN ISO 8573-1 class 4

Accessories

	Item no.
Snap-in piINLINE® 5x MICRO mounting bracket	0123093